

## To install the parking station

Ensure the space to assemble the parking station is enough to allow the correct connection & disconnection in an ergonomic way.  
Check the drawing of the parking station.

Fix the parking station body on the machine or the frame of the attachment using fixing screws as indicated in the drawing of the corresponding parking station.

Please verify the parking station is placed "face up".

## DP

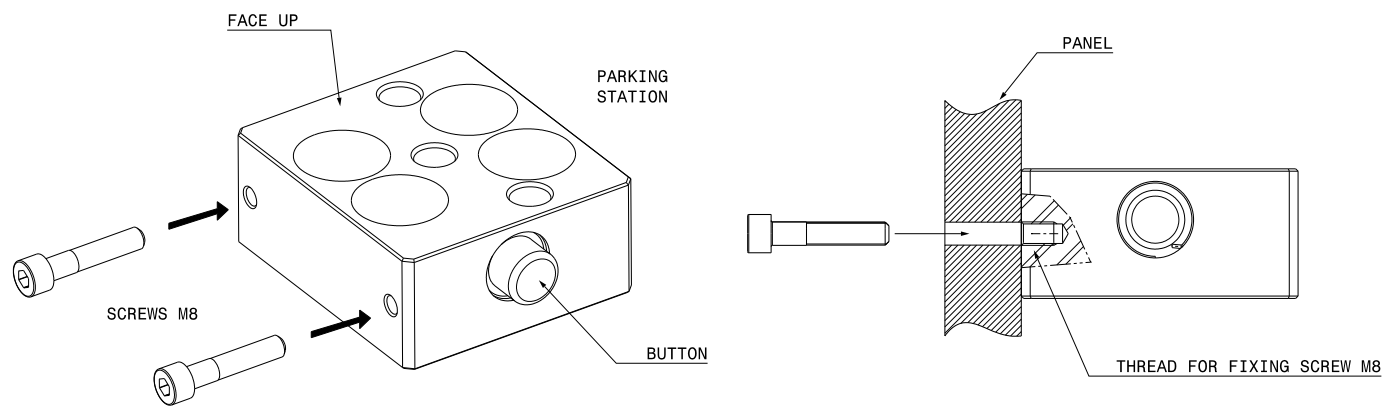

## GR

